

Search Reference:	CU/2017/09511	Regional Property Certificate Unit County Buildings 15 East Bridge Street ENNISKILLEN BT74 7BW
Map Sheet Reference:	16010SE	
Property Address:	LANDS AT, BALLYGAWLEY ROAD DUNGANNON	
Date:	27-Apr-2017	Scale: 1: 1250

This material is Crown Copyright and is reproduced with the permissions of Land & Property Services under delegated authority from the Controller of Her Majesty's Stationery Office, © Crown Copyright and database right 2010. NIMA No. EMOU 206.1

Proposed levels and site construction details as per civil engineers drawings.

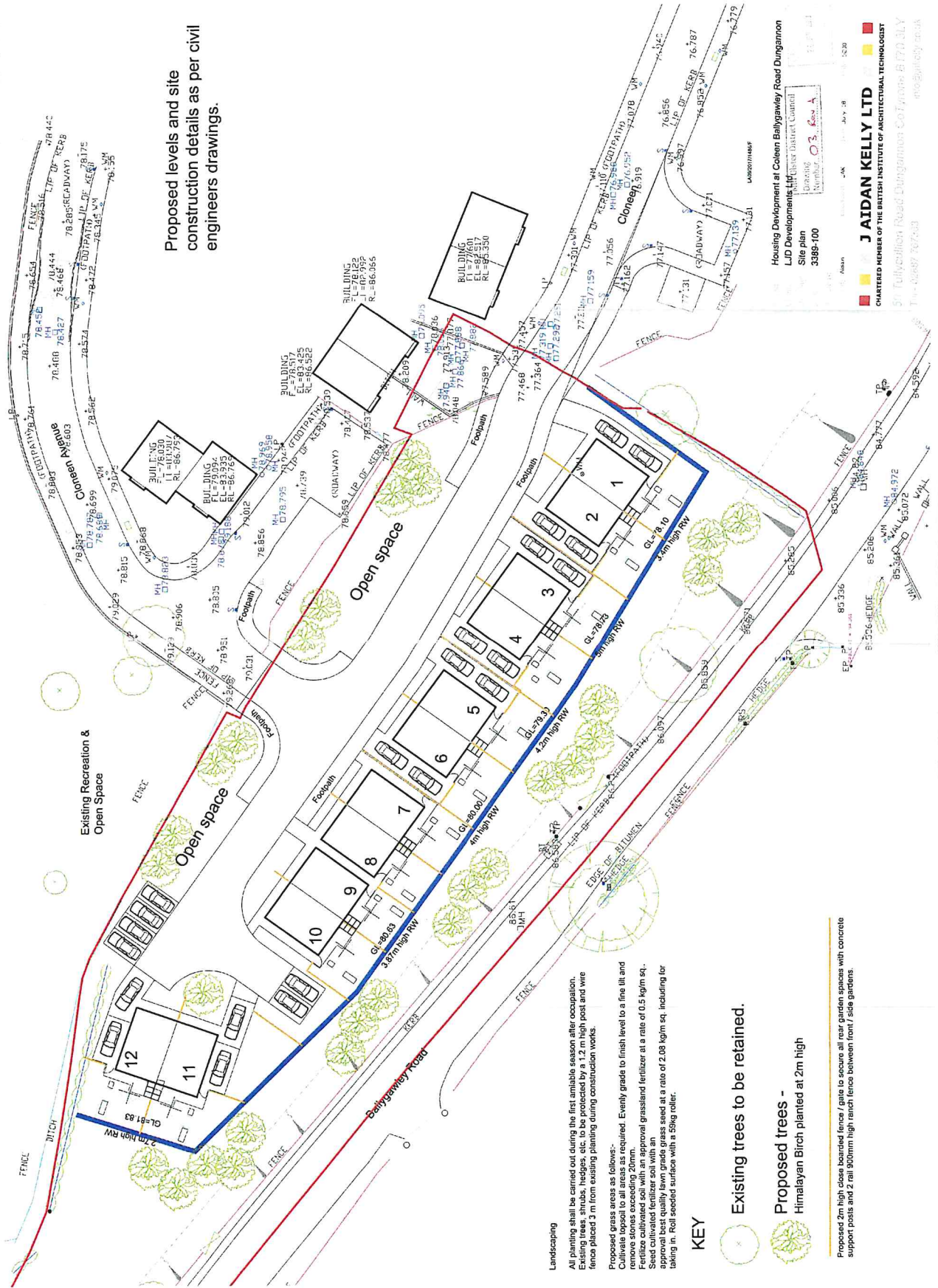

Landscaping

All planting shall be carried out during the first amiable season after occupation. Existing trees, shrubs, hedges, etc. to be protected by a 1.2 m high post and wire fence placed 3 m from existing planting during construction works.

Proposed grass areas as follows:-
 Cultivate topsoil to all areas as required. Evenly grade to finish level to a fine tilt and remove stones exceeding 20mm.
 Fertilize cultivated soil with an approval grassland fertilizer at a rate of 0.5 kg/m sq.
 Seed cultivated fertilizer soil with an approval best quality lawn grade grass seed at a rate of 2.08 kg/m sq. including for taking in. Roll seeded surface with a 50kg roller.

KEY

- Existing trees to be retained.
- Proposed trees - Himalayan Birch planted at 2m high

Proposed 2m high close boarded fence / gate to secure all rear garden spaces with concrete support posts and 2 rail 900mm high ranch fence between front / side gardens.

Housing Development at Colleen Ballygawley Road Dungannon
 LJD Developments Ltd
 Site plan
 3395-100
 Planning Number: 03
 Date: July 18
 Scale: 1:200

J AIDAN KELLY LTD
 CHARTERED MEMBER OF THE BRITISH INSTITUTE OF ARCHITECTURAL TECHNOLOGISTS
 91 Tullycotton Road Dungannon Co Fermanagh BT70 3JL
 Tel: 02827 267231
 email: aidan@jkelly.co.uk